

PRODUCT DATA SHEET

SKP STANDARD TYPE CABLE LUG



DESCRIPTION

A cable lug is attached to an electrical device such as a wire or cable and then securely fastened to its end using a crimp tool and crimp die.

FEATURES

- Made of copper material in accordance with EN/13600 standards.
- Annealed copper pipes are used during production.
- Copper with 99.9% conductivity is used in production.
- 100% Tin coating is made in the range of 5-8 Microns.

MARKINGS



- It complies with CE standards.
- It complies with RoHS standards.
- It complies with ISO 9001 standards.
- It complies with IEC standards.
- It complies with TSE standards.
- Domestic Production.

PRODUCT DATA SHEET

SKP STANDARD TYPE CABLE LUG

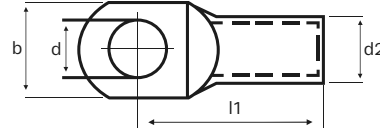
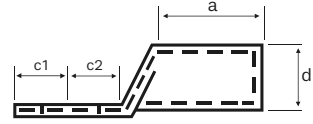

SECTIONS AND DIMENSIONS

PRODUCT CODE	CABLE SECTION (mm ²)	BORE DIAMETER Ø	DIMENSIONS							
			d	d1	d2	l1	a	b	c1	c2
SKP-S 95-8	95 mm ²	M8	8,5	13,5	16,7	48,8	26,0	24,7	10,0	12,0
SKP-S 95-10		M10	10,5	13,5	16,7	48,8	26,0	24,7	10,0	12,0
SKP-S 95-12		M12	13,0	13,5	16,7	48,8	26,0	24,7	10,0	12,0
SKP-S 120-10	120 mm ²	M10	10,5	15,6	19,0	56,0	29,0	27,7	13,0	14,5
SKP-S 120-12		M12	13,0	15,6	19,0	56,0	29,0	27,7	13,0	14,5
SKP-S 120-14		M14	15,0	15,6	19,0	56,0	29,0	27,7	13,0	14,5
SKP-S 120-16		M16	17,0	15,6	19,0	56,0	29,0	27,7	13,0	14,5
SKP-S 150-10	150 mm ²	M10	10,5	16,5	21,0	60,0	30,0	30,4	16,5	16,5
SKP-S 150-12		M12	13,0	16,5	21,0	60,0	30,0	30,4	16,5	16,5
SKP-S 150-14		M14	15,0	16,5	21,0	60,0	30,0	30,4	16,5	16,5
SKP-S 150-16		M16	17,0	16,5	21,0	60,0	30,0	30,4	16,5	16,5
SKP-S 185-10	185 mm ²	M10	10,5	18,4	23,0	65,5	33,0	34,2	17,0	18,0
SKP-S 185-12		M12	13,0	18,4	23,0	65,5	33,0	34,2	17,0	18,0
SKP-S 185-14		M14	15,0	18,4	23,0	65,5	33,0	34,2	17,0	18,0
SKP-S 185-16		M16	17,0	18,4	23,0	65,5	33,0	34,2	17,0	18,0
SKP-S 240-10	240 mm ²	M10	10,5	21,0	26,0	72,0	38,0	38,7	17,0	18,0
SKP-S 240-12		M12	13,0	21,0	26,0	72,0	38,0	38,7	17,0	18,0
SKP-S 240-14		M14	15,0	21,0	26,0	72,0	38,0	38,7	17,0	18,0
SKP-S 240-16		M16	17,0	21,0	26,0	72,0	38,0	38,7	17,0	18,0
SKP-S 300-12	300 mm ²	M12	13,0	23,4	28,6	77,0	41,0	42,6	18,0	18,0
SKP-S 300-14		M14	15,0	23,4	28,6	77,0	41,0	42,6	18,0	18,0
SKP-S 300-16		M16	17,0	23,4	28,6	77,0	41,0	42,6	18,0	18,0